

Specifications

General	
Dimensions (W x H x D):	210 x 44 x 167 mm (8 3/8 x 1 3/4 x 6 5/8 inches)
Mass	Approx. 1.5 kg (3 lb 1 oz)
Power	Power consumption; Approx. 45 W Power supply; DC 13.5 V provided from an AC adapter
Operating temperature	+5 to +40°C (+42 to +104°F)
Storage temperature	-20 to +55°C (-4 to +131°F)
Hard Disk Drive	40 GB
Output (Media Formats)	
MPEG-2	Video MPEG-2 MP@ML, 4.0 Mb/s - 9.0 Mb/s Audio MPEG-1 Audio Layer II 2 channels (fixed), 256 kb/s, 48 kHz
Graphics	Bitmap (.bmp), JPEG (.jpg), FLASH (.swf), HTML (.htm or .html)
Text	Bitmap (.bmp), Text (.txt)
Audio	Linear Audio (.wav), MP3 (.mp3)
AV In	NTSC, PAL Stereo Audio
Output (Screen Image)	
Analogue RGB	VGA (640 x 480 pixels), WVGA (848 x 480 pixels), SVGA (800 x 600 pixels), XGA (1024 x 768 pixels)
Composite Video*	NTSC (720 x 480 pixels), PAL (720 x 576 pixels)
Screen Rotation	Landscape, Portrait (+90°, -90°)
Interface	
Video OUT	Analogue RGB, HD D-sub 15-pin (female) x1 Composite (RCA phono type x1)
Audio OUT	Stereo RCA phono type x2, analogue unbalanced
Video IN	Composite (RCA phono type x1)
Audio IN	Stereo RCA phono type x2, analogue unbalanced
Network	10/100Base-T Ethernet, RJ-45 modular jack x1
PCMCIA	Type II x1
USB	USB 1.1 x2
Serial	RS-232C, D-sub 9-pin (male) x1
GPI	D-Sub 25-pin (female) x1
Operating System and Network	
Operating system:	Linux
Supporting protocols:	TCP/IP, HTTP
Supplied Accessories	
	AC adapter and AC cable
	Stand for desktop mounting in vertical position
	Operation manual (downloadable from the NSP-1 HDD)
	BZNP-D1LE (Light Edition SW, downloadable from NSP-1 HDD)

* Simultaneous output of Analogue RGB and Composite Video is not available

Front Panel



Rear Panel



©2004 Sony Corporation. All rights reserved. Reproduction in whole or in part without written permission is prohibited. Design, features and specifications are subject to change without notice. All non-metric weights and measures are approximate. Sony is a registered trademark of Sony Corporation. All other trademarks are the property of their respective owners. Some images in this brochure are simulated. CA NSP-1/GB- / /2004

SONY

SONY EUROPE

www.sonybiz.net

SONY

NSP-1
Network Player

PC System Requirements⁵

Hardware Requirements

Operating System:	Microsoft® Windows® XP Professional (SP1a)
Processor:	Intel® Pentium® 4, 1 GHz or higher (or compatible microprocessor)
Memory:	256 MB RAM or more
Display:	1024 x 768 pixels or greater
Graphics Card:	32-bit colour video display adapter (OpenGL card recommended)
Network Interface:	100Base-TX
Sound Card:	Microsoft® DirectX® compatible sound card
HDD:	100 MB available space for installation

Software Requirements⁶

- Microsoft® Internet Explorer 6.0 or higher
- Microsoft® Windows® Media Player Version 9 or higher
- Microsoft® DirectShow® Version 9.1 (including DirectX® 9.1) must be installed
- Software supporting the MPEG-2 CODEC⁷ (DirectShow® compatible) must be installed

5 A network environment and a PC with network capability are required.

6 Software applications required to create material for playout, such as graphics, video, Flash files, etc. must be purchased separately. Please contact your local Sony sales office for more details on software requirements.

7 MPEG-2 CODEC is supported in applications such as Canopus ProCoder Express, WinDVD, PowerDVD, and DVDIt!

Dynamic Digital Signage.



You make it a Sony

NSP-1

Energise Your Digital Signage - A New Level of Dynamics

The mission of marketing managers and business owners has always been to reach their target market with the right promotional message to turn potential customers into customers. Today, one of the best ways to achieve this is by using dynamic digital signage driven by the Sony NSP-1 Network Player.

Equipped to handle many layers of high-quality graphics, text, and video, the NSP-1 is ideal for delivering dynamic programming directly to customers. From Macromedia® Flash™ to HTML and from still to video pictures, it's all available and easy to present with the NSP-1 Network Player. Other features include portrait mode, a dedicated audio track, and an option to feed live video to the unit, which help to make your digital signage more versatile.

Make the powerful NSP-1 the engine that drives your revenue-generating digital signage solutions.

Features

Versatile Content Presentation

The NSP-1 is capable of producing up to five image layers for display, including graphics, video and text. What's more, the NSP-1 has the flexibility to either present video stored on its HDD or a live video feed that can be played out along with the other layers. Also, in addition to the audio accompanying the video, an extra audio channel is available for background music or narration.

High-Quality Graphics and Text

The NSP-1 supports a variety of graphics including full-colour bitmap (.bmp), JPEG, Macromedia Flash and HTML. Small bitmap images, which are ideal for logos, can be presented at any location on the display. In addition, text can be set for display in any colour and in any location on the screen, and can be scrolling, flashing or still.

Excellent Video Quality

Supporting MPEG-2 video at a high bit rate, the NSP-1 presents clear, true-to-life DVD quality video images.

Portrait Mode¹

Both portrait and landscape modes are available for presenting content. In portrait mode, the display can be rotated 90° clockwise or counterclockwise.

Selectable Output Resolution and Aspect Ratio

Image resolution and aspect ratios can be selected from the following:

- 4:3 RGB: VGA, SVGA, XGA
- 16:9 RGB: WVGA
- 4:3 Composite Video: NTSC, PAL

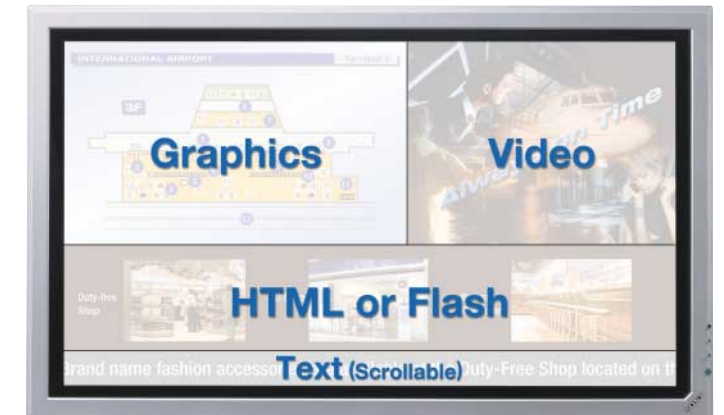

simulated image

Dedicated Audio Track

A dedicated audio track is ideal for presenting background music or narrations that accompany video and graphics.

Browser-Based Remote Setting & Schedule Confirmation

The NSP-1 comes with a pre-installed easy-to-use menu that can be accessed from a PC browser,² and can be used to control the unit or confirm playout schedules.

Dynamic Content Transition

Not only can the NSP-1 display a variety of content, it has the versatility to dynamically change the displayed content in accordance with a user specified playlist. Stored content, including graphics, Flash, text, and video, can be automatically updated in a timely manner. Also, regularly updated web pages are displayed for time sensitive information. What's more, a live video signal can be input to the NSP-1 so that the displayed video transitions from stored video to live video are in accordance with the playlist.

¹ When the NSP-1 is set to portrait mode, HTML, Flash, Graphics, and text are the only contents displayed in portrait orientation.

² Microsoft® Internet Explorer 6.0 or higher is required.



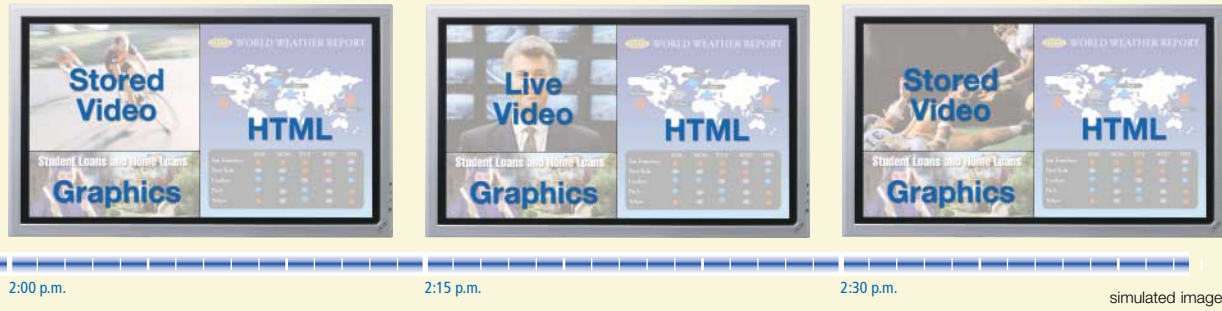

Flexible Setting Layout with Wireless LAN³

The NSP-1 has a wireless LAN capability that allows multiple units to be placed in various locations within a building - ideal if the units will be moved around frequently for special promotions. This wireless configuration not only affords the flexibility to position the units as required, but it also keeps unsightly wires from cluttering displays.

Versatile Interfaces for System Customisation

A wide range of interfaces allows for custom configurations to satisfy even the most demanding customers. Interfaces include a PC card slot, RS-232C port, a 25-pin GPI, and two USB ports.

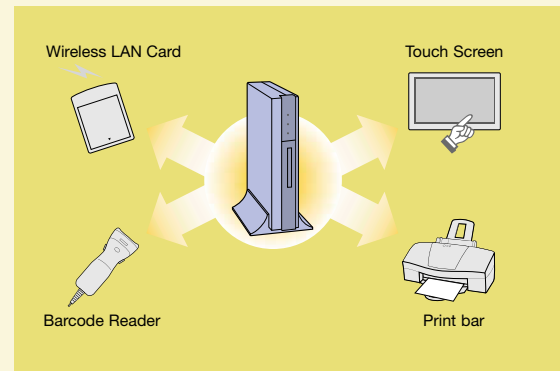

³ Contact your local Sony office for a list of wireless LAN cards that are compatible with the NSP-1.

Network Player Management Software

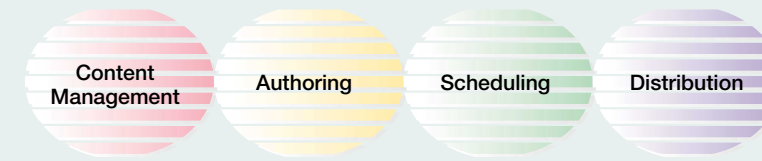

Ziris™

Digital signage has the potential to provide your audiences with compelling information, but poorly designed messages or black screens can easily become intrusive and irritating. As a result, the content that you display on screen becomes vitally important. It has to be carefully tailored to your audiences and their expectations.

Sony Ziris™ software is innovative technology that brings high-quality, tailored messages to your target audiences. It allows you to control your screen-based communications network in a very easy and user-friendly manner, and target your audiences with unrivalled playback quality, 24 hours a day, 7 days a week. Plus, it enables you to stay focused on network operations without wasting time and costs to solve unforeseen situations.

Ziris Create™. Create your own vision.

Ziris Create™ powers a large variety of screens with very high-impact media. This allows you to take advantage of the effects of information, entertainment and advertising on passing traffic or captive target audiences. Ziris Create™ offers enormous creative freedom – up to broadcast playback quality. And with an easy-to-use, intuitive user interface, unique to Ziris Create™, you don't have to be a professional media artist to operate it. You can integrate and customise materials from multiple sources (video, audio, picture and text files), and program it to offer tailored content at each individual screen or location.

Ziris™ software enables you to:

- Target your audience with impactful and effective messages on a flexible mix of high-quality screens
- Distribute your media creations over any kind of network at high speed and in a cost-effective manner
- Proactively organise and monitor communications campaigns with 24x7 playback monitoring from remote places
- Seamlessly integrate all hardware with your network and communications requirements
- Support, monitor and service your digital signage networks and its components.

System configuration

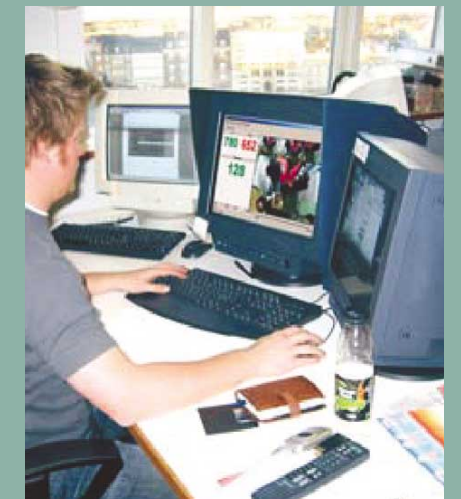
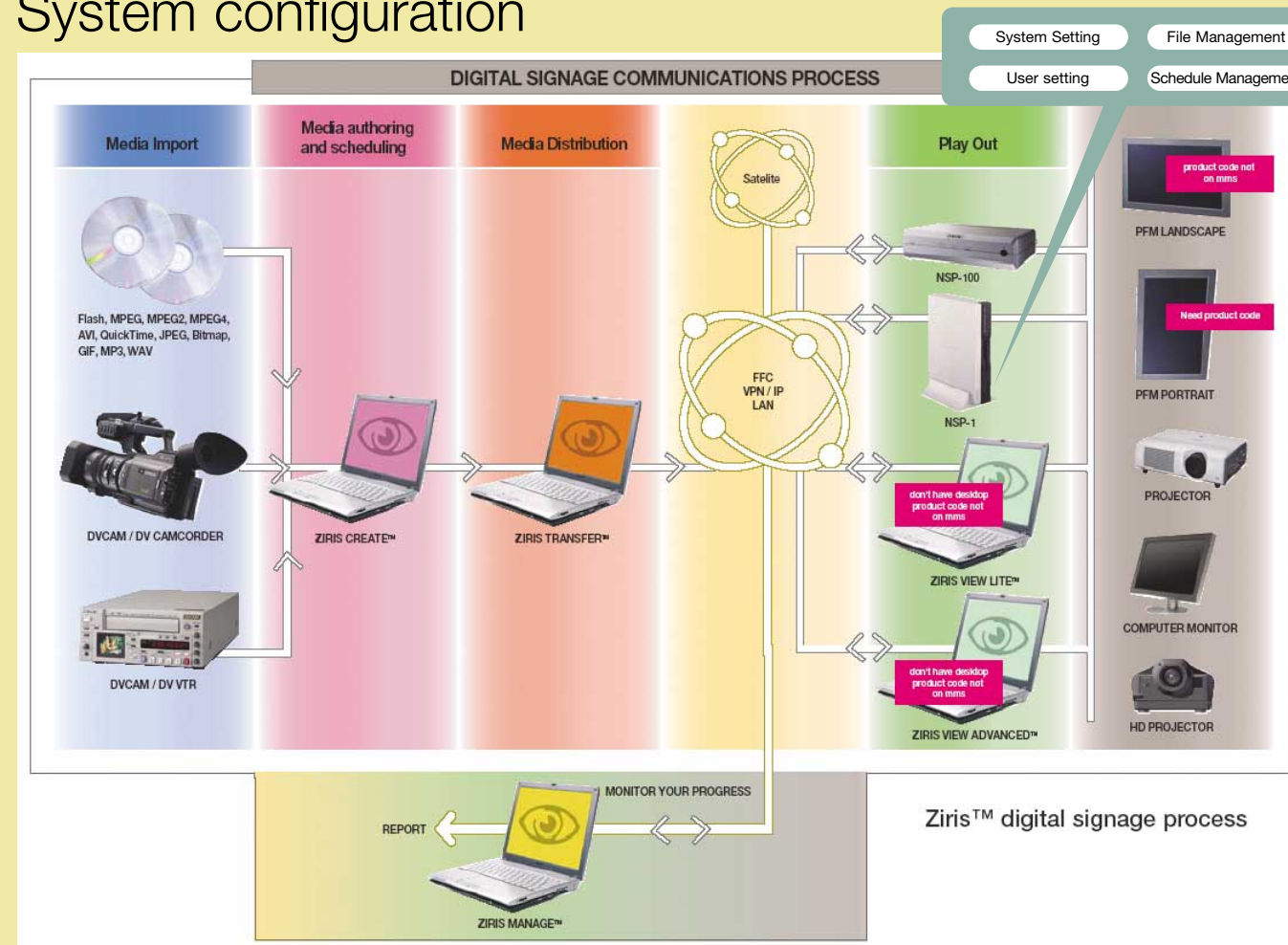

In an editing suite realised by Sony, a media artist creates the most stunning video clips to go live on a Ziris™ digital signage network, in just a matter of minutes.



Ziris Transfer™. Make your image move.

Now that you've created your stunning programme materials using Ziris Create™, it's time to get your own messages across: at the right time, in front of the right audiences. Ziris Transfer™ allows you to distribute your messages to a variety of storage devices. You can tailor your advertising programmes, corporate information or live video feeds in a reliable, easy and cost-effective way. Delivery of Ziris™ digital signage content to each storage location can be by the many networks that are now available – satellite, local area networks (LANs), wide area networks (WANs) or the Internet. The choice of network depends on the requirements you have of your digital signage network, and Sony can help you make the right choice for the optimal performance you need.

Store and play your creation.

Most digital signage solutions offer the customer a limited choice of hardware and software capabilities. Sony understands that different business requirements can only be addressed comprehensively by providing a large freedom choice. To cater for this, Sony has designed Ziris™ software to support a mix of different screens and projectors. It's also fully compatible with a range of network players that allow you to store and play out programmed media to many different screens. These include the Sony network players NSP-100, NSP-1 and Ziris View™ PC players, which offer distinct advantages for differing location, application and on-screen media design requirements. For example the NSP series players are best suited to applications requiring high-quality playback of video-based images, whereas a PC player solution is more appropriate when you require more complex image designs.

With Ziris View™ software, you can transform any standard PC into a digital signage player and replay complex on-screen images containing multiple layers of video, animation and text. Thanks to its open architecture, Ziris View™ software also enables the creation of many other applications. For example, your scales, payment kiosks, music download portals and digital printing kiosks can potentially all become part of your digital signage platform.

Ziris Manage™. Monitor your messages.

Black screens in your store... a network breakdown during the annual corporate message to your employees... there are many potential nightmares for digital signage users. To prevent them from becoming a reality, you need to be absolutely sure that your technology will stay up and running 24x7. When managing a network of devices, the reliability and usability of the system makes all the difference. With Ziris Manage™, thanks to its real-time and automatic monitoring capability, it's the administrator who knows first if there is a hardware breakdown – not the store manager or your audience. Ziris Manage™ is designed to deliver appropriate and prompt feedback via a unique communication feature that generates and sends alert messages automatically to administrators and their assistants.

Service and support from Sony

Sony Ziris™ comes with a 12-month Sony PrimeSupport® package, including access to a telephone helpdesk from Monday to Friday during working hours, notification of all software upgrades, and bug fixing. Maintenance will be made available to customers 24x7 through the secure Sony PrimeSupport® website facilities.

Ziris™, a seamless vision.

As a leading company in audio and visual communications, Sony developed Ziris™ for reliable, cost-effective and easy-to-use digital signage solutions. The Ziris™ family of software packages is designed to power and monitor a network of screens. It allows you to create, target and display high-impact media and to proactively organise, deliver and support digital signage networks. We work closely with our customers to ensure that future digital signage developments are fully compliant with professional needs.

The products within the Ziris range are:

Ziris Create	Product Code:	BZSQ-CREATE
Ziris Transfer	Product Code:	BZSQ-TFR CH10 BZSQ-TFR DV50 BZSQ-TFR CDN BZSQ-TFR SRV LT BZSQ-TFR SRV 500 BZSQ-TFR CLIENT
Ziris View	Product Code:	BZSQ-VIEWLite BZSQ-VIEW500
Ziris Manage	Product Code:	BZSQ-MANAGE10

Ziris™ system requirements

Operating system

Microsoft® Windows® XP Professional SP1 or Microsoft Windows 2000

CPU

Intel® Pentium® 4, 2.8 GHz or higher

Memory

512 MB or more

Monitor

1024 x 768 resolution, true colour.

Internet functionality requirements

Some Internet functionality may require Internet access and payment of a separate fee to a service provider; local or long distance charges may apply. Internet functionality requires 56k or higher baud modem or xDL or cable modem.